

# Medical Dewar Parts Illustrated

*Ratermann  
Manufacturing  
maintains a  
large inventory  
of Companion®  
system  
replacement  
parts. Our parts  
are of the  
highest quality.*



## INDEX

### **Companion® System**

- Companion® 550 Parts Illustrated..... **1E-2**
- Companion® 1000 Parts Illustrated..... **1E-3**
- Companion® Stationary Parts Illustrated..... **1E-4**

### **Replacement Parts**

- Caire® Equipment..... **1E-8-9**
- P.B. Companion Equipment..... **1E-5-7**

### **Filling Equipment and Accessories**

- Companion®, Mark®, and Caire® Equipment..... **1E-7, 10**
- Teflon Tape, and Green Oxygen Teflon Tape ..... **1E-10**

# COMPANION<sup>®</sup> SYSTEM

## RMI Parts for **COMPANION<sup>®</sup> 550 - PARTS ILLUSTRATION**

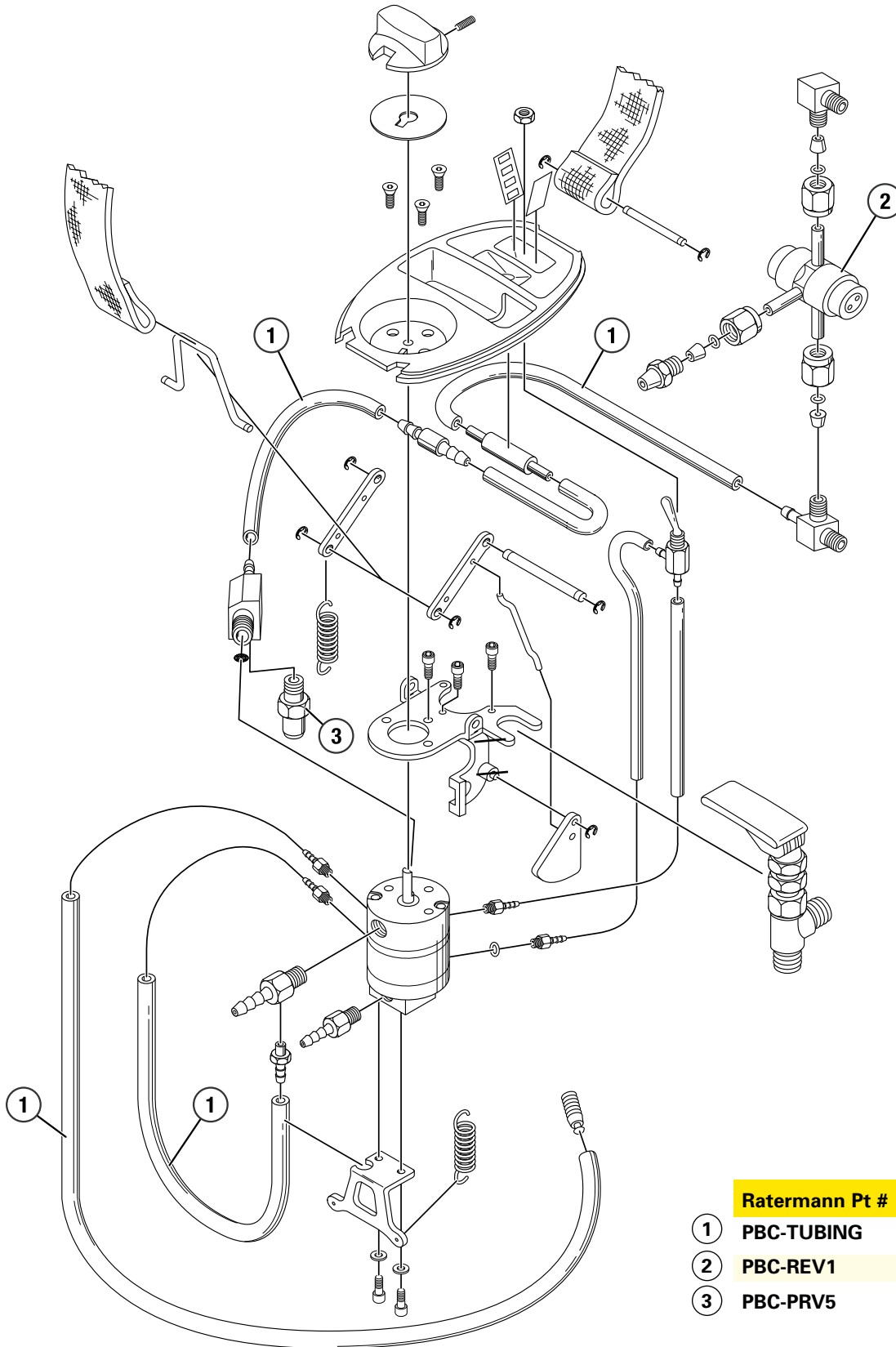

	Ratermann Pt #	Page
1	PBC-TUBING	1E-7
2	PBC-REV1	1E-5
3	PBC-PRV5	1E-5

# COMPANION® SYSTEM

Medical Dewar  
Parts Illustrated  
Section  
**1E**

## RMI Parts for COMPANION® 1000 - PARTS ILLUSTRATION

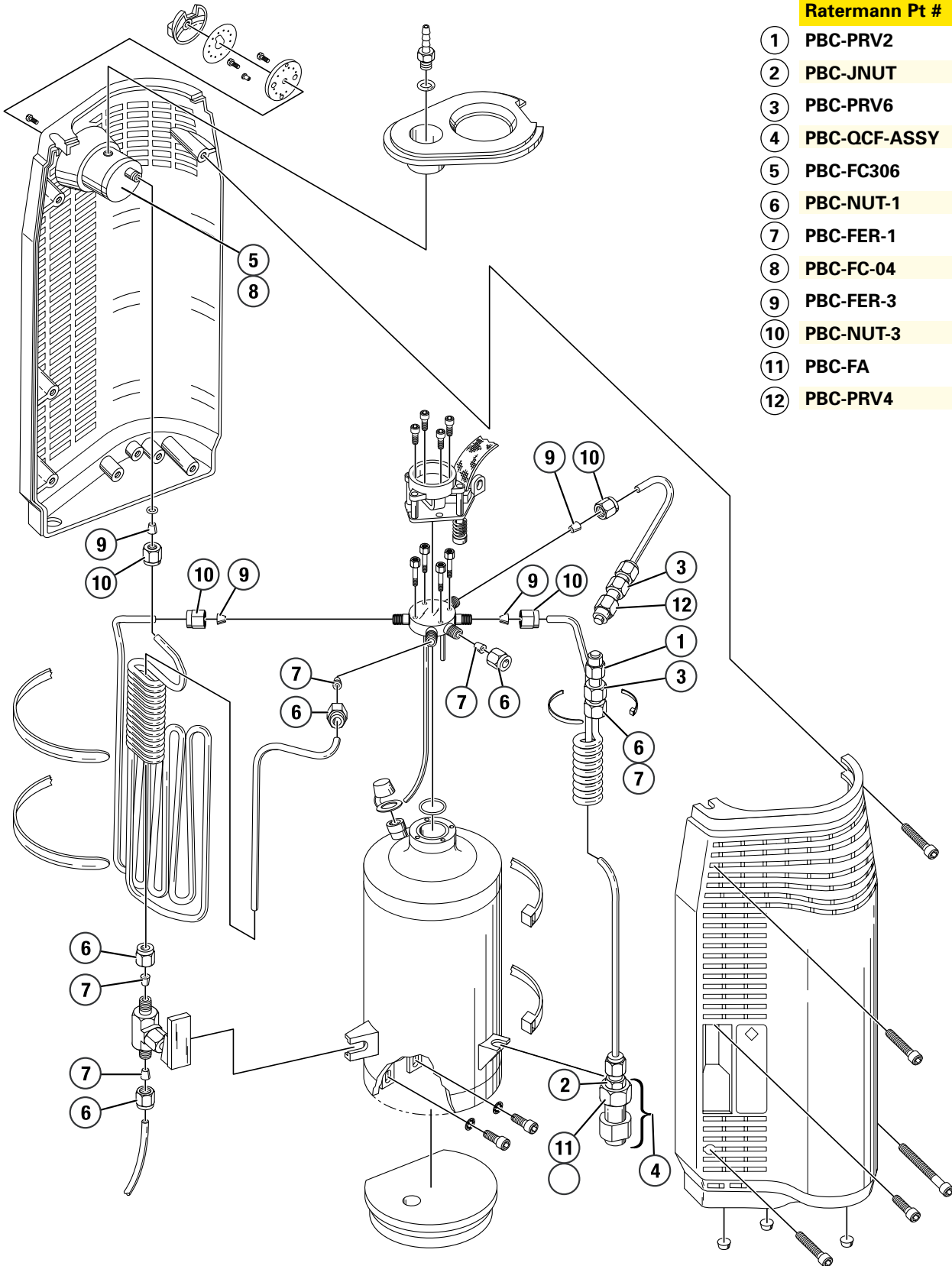

	Ratermann Pt #	Page
①	PBC-PRV2	1E-5
②	PBC-JNUT	1E-6
③	PBC-PRV6	1E-5
④	PBC-QCF-ASSY	1E-6
⑤	PBC-FC306	1E-5
⑥	PBC-NUT-1	1E-7
⑦	PBC-FER-1	1E-7
⑧	PBC-FC-04	1E-5
⑨	PBC-FER-3	1E-7
⑩	PBC-NUT-3	1E-7
⑪	PBC-FA	1E-6
⑫	PBC-PRV4	1E-5

# COMPANION<sup>®</sup> SYSTEM

## RMI Parts for COMPANION<sup>®</sup> STATIONARY - PARTS ILLUSTRATION

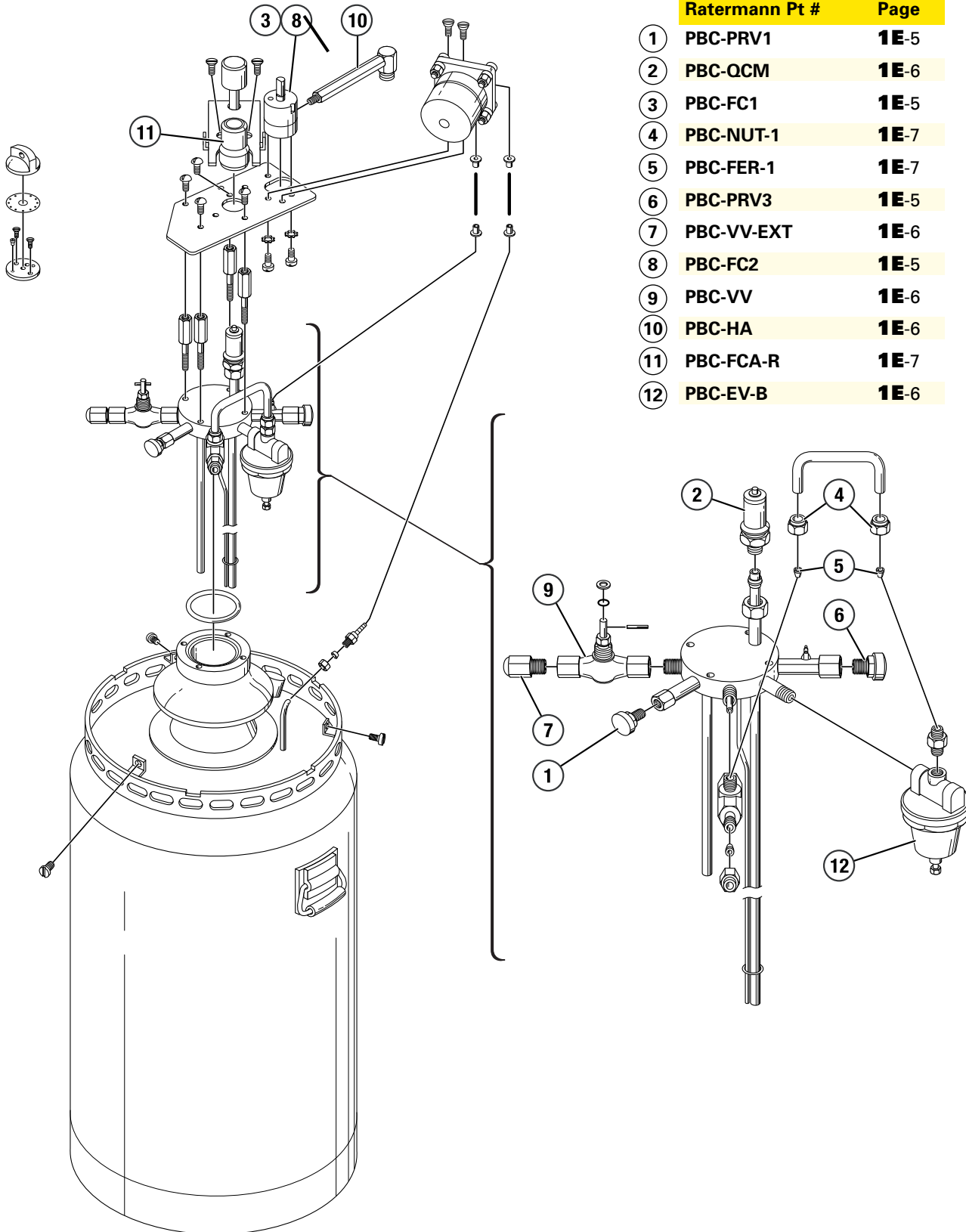

Ratermann Pt #	Page	
1	PBC-PRV1	1E-5
2	PBC-QCM	1E-6
3	PBC-FC1	1E-5
4	PBC-NUT-1	1E-7
5	PBC-FER-1	1E-7
6	PBC-PRV3	1E-5
7	PBC-VV-EXT	1E-6
8	PBC-FC2	1E-5
9	PBC-VV	1E-6
10	PBC-HA	1E-6
11	PBC-FCA-R	1E-7
12	PBC-EV-B	1E-6

- | Ratermann Pt # | Page       |      |
|----------------|------------|------|
| 1              | PBC-PRV1   | 1E-5 |
| 2              | PBC-QCM    | 1E-6 |
| 3              | PBC-FC1    | 1E-5 |
| 4              | PBC-NUT-1  | 1E-7 |
| 5              | PBC-FER-1  | 1E-7 |
| 6              | PBC-PRV3   | 1E-5 |
| 7              | PBC-VV-EXT | 1E-6 |
| 8              | PBC-FC2    | 1E-5 |
| 9              | PBC-VV     | 1E-6 |
| 10             | PBC-HA     | 1E-6 |
| 11             | PBC-FCA-R  | 1E-7 |
| 12             | PBC-EV-B   | 1E-6 |

# REPLACEMENT PARTS

## RMI Parts for **FOR P. B. COMPANION® EQUIPMENT**



*Flow Control Valve*  
C-21, 31, 41 0-6 LPM  
12 position  
Part # PBC-FC1



*Primary Relief Valve*  
C-1000  
1/8" 22 PSI  
Part # PBC-PRV2



*Flow Control Valve*  
C-21, 31, 41 0-10 LPM  
(high flow)  
12 position  
Part # PBC-FC2

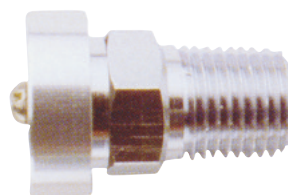

*Secondary Relief Valve*  
C-21, 31, 41  
1/4" 30 PSI  
Part # PBC-PRV3



*Flow Control Valve*  
C-1000 0-6 LPM  
12 position  
Part # PBC-FC306



*Secondary Relief Valve*  
C-1000 1/8" 30 PSI  
Part # PBC-PRV4

*Pediatric Flow Control Valve*  
C-1000 0-4 LPM  
12 position  
Part # PBC-FC-304

C-550 1/8" 45 PSI  
Part # PBC-PRV5



*Flow Control Valve*  
C-1000T 0-15 LPM  
12 position  
Part # PBC-FC-04



*Relief Valve Connector*  
Portable 18"  
(all portable units)  
Part # PBC-PRV6

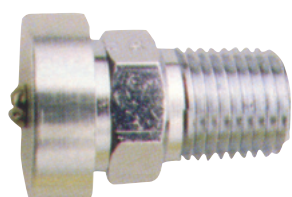

*Primary Relief Valve*  
C-21, 31, 41  
1/8" 22 PSI  
Part # PBC-PRV1



*Relief Economizer Valve*  
C-500/550 (aluminum)  
Part # PBC-REV1

# REPLACEMENT PARTS

RMI Parts for **FOR P. B. COMPANION® EQUIPMENT**



*Quick Connect  
(Male)*  
C-21, 31, 41  
Part # PBC-QCM

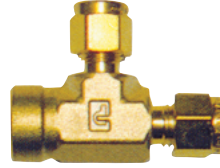

*Warming Coil  
"T" Assembly*  
C-21, 31, 41  
Part # DTF-4-4-B



*Quick Connect Assembly  
(Female)*  
C-1000 C-500/550  
Part # PBC-QCF-ASSY



*Vent Valve  
Extension  
with Orifice*  
C-21, 31, 41  
Part # PBC-VV-EXT

*Jam Nut for Portable Units*  
C-1000, T, 500, 550  
Part # PBC-JNUT



*Female Adapter  
(for Female Quick  
Connect)*  
Part # PBC-FA



*Vent Wrench*  
C-21, 31, 41  
Part # PBC-VW

*Seal, Female Adapter*  
12 position  
Part # PBC-FA-SEAL



*Lip Seal  
(Quick Connect Female)*  
C-1000, T, C-500/550  
Part # PBC-SEAL-LIP



*Humidifier Adapter*  
C-21, 31, 41  
Part # PBC-HA

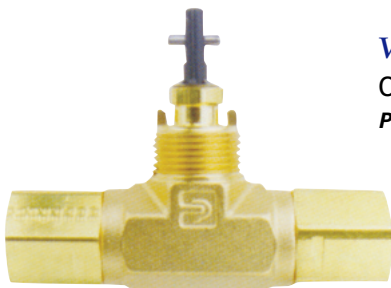

*Vent Valve*  
C-21, 31, 41  
Part # PBC-VV



*Economizer Valve*  
C-21, 31, 41 (brass)  
Part # PBC-EV-B

# REPLACEMENT PARTS

## RMI Parts for **FOR P. B. COMPANION® EQUIPMENT**



*Economizer Valve*  
C-21, 31, 41  
(aluminum)  
Part # PBC-EV-A



*Fill Connector Actuator - Release*  
C-21, 31, 41  
Part # PBC-FCA-R



*Strap*  
C-1000 (black)  
Part # PBC-STRAP1



*Relief Valve Silencer*  
1/8" C-1000 Portable  
Part # PBC-RVS



*Strap*  
C-550/500 (black)  
Part # PBC-STRAP2

*Oxygen Outlet*  
Companion® Portable  
Part # PBC-OO



*Shroud Washer*  
C-21, 31, 41  
Part # PBC-WASHER



*Shroud Screw*  
C-21, 31, 41  
Part # PBC-SCREW

## FILLING EQUIPMENT & ACCESSORIES

### RMI Parts for **FOR COMPANION®, MARK®, & CAIRE® EQUIPMENT**

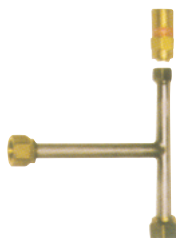

*Source Adapter Assembly with Relief Valve*  
Part # CC-SA-ASSY-RV



*Vent Wrench*  
C-21, 31, 41  
Part # PBC-VW



*Seal Kit*  
for Krytox Swivel Fill Head Assembly / In-line Swivel  
Part # CC-SEAL-KIT

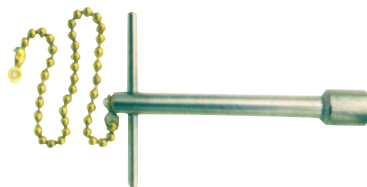

*Reservoir Vent Wrench*  
with chain Mk-2, 3, 4  
Part # CC-RVW



*70 lb. Scale Base Assembly*  
(Companion®)  
Part # PBC-SCALE-ASSY

*Scale Cover*  
(Companion®)  
Part # PBC-SCALE-CVR

# REPLACEMENT PARTS

RMI Parts for **FOR CAIRE® EQUIPMENT**

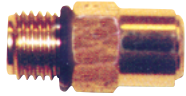

*Primary Relief Valve  
with O-Ring*  
23 PSI,  
Generation 3 Stationary  
Part # **CE-PRV-G35-12**



*Flow Control Valve*  
Generation 2 Stroller  
12 position 0-6 LPM  
Part # **CE-FCV-G2-12**

*Secondary Relief Valve  
with O-Ring*  
30 PSI,  
Generation 3 Stroller  
Part # **CE-SRV-G3-30**

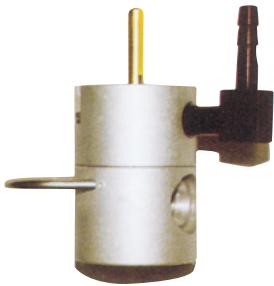

*Flow Control Valve*  
Generation 3 Stroller,  
Bottom Inlet  
12 position 0-6 LPM  
Part # **CE-FCV-G3-12-BI**

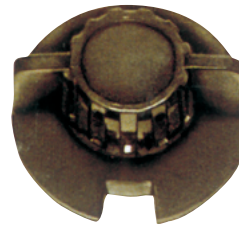

*Flow Control  
Valve Knob*  
Generation 2 Stroller  
or Stationary  
12 position  
Part #  
**CE-FCV-G2/S-12-KNOB**

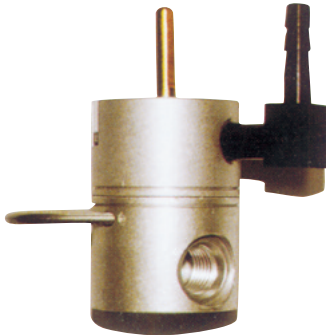

*Flow Control Valve*  
Generation 3 Stroller,  
Side Inlet  
12 position 0-6 LPM  
Part # **CE-FCV-G3-12-SI**



*Flow Control Valve  
Number Disk*  
Generation 2 Stroller  
or Stationary  
12 position  
Part #  
**CE-FCV-G2/3-12-DISK**



*Flow Control Valve*  
Generation 2  
Stationary, Side Inlet  
12 position 0-6 LPM  
Part #  
**CE-FCV-G2S-12-SI**

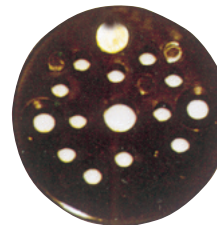

*Flow Lock Plate*  
Generation 2 Stroller  
or Stationary  
12 position  
Part # **CE-FLP G2/S-12**

# REPLACEMENT PARTS

## RMI Parts for **FOR CAIRE® EQUIPMENT**

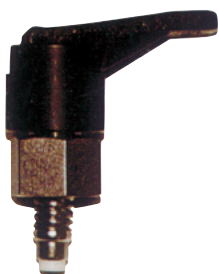

*Vent Valve w/ Handle*  
Generation 3 Stroller  
Part # **CE-VV-G3**



*Caire® Strap*  
Generation  
2 Stroller/  
Sprint  
Part # **CE-G2-STRAP**

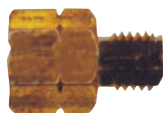

*Primary Relief Valve  
Connector w/ Orifice*  
Generation 3 Stroller  
Part #  
**CE-PPV-G3-CONN**



*Male Quick  
Connect*  
P.B. Style  
Generation  
3 Stationary  
Part # **CE-MQC-G3**



*Caire® Vent Wrench*  
All Stationary Units  
Part # **CE-VW**

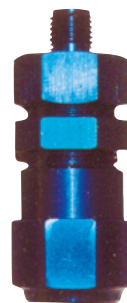

*Female Quick  
Connect*  
P.B. Style  
Generation  
3 Stroller  
Part # **CE-FQC-G3**

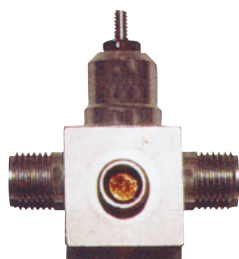

*Economizer Valve  
w/ Relief Port*  
Generation 3 Stroller  
12 position 0-6 LPM  
Part # **CE-EVRP-G3-12**



*Krytox 2 oz. Tube*  
Part # **KRY-GPL2262OZ**

# FILLING EQUIPMENT & ACCESSORIES

**RMI** Parts for **FOR COMPANION,<sup>®</sup> MARK,<sup>®</sup> & CAIRE<sup>®</sup> EQUIPMENT**



### Hose & Diffuser –

Armored Hose CGA-295 with 1/8" Diffuser

Part #	Hose Length	Description
FPA4D18	4'	CGA-295 w/ 1/8" Diffuser
FPA6D18	6'	CGA-295 w/ 1/8" Diffuser
FPA8D18	8'	CGA-295 w/ 1/8" Diffuser
FPA12D18	12'	CGA-295 w/ 1/8" Diffuser

### Hose & Diffuser –

Armored Hose CGA-295 with 3/8" Diffuser

Part #	Hose Length	Description
FPA4D38	4'	CGA-295 w/ 3/8" Diffuser
FPA6D38	6'	CGA-295 w/ 3/8" Diffuser
FPA8D38	8'	CGA-295 w/ 3/8" Diffuser
FPA12D38	12'	CGA-295 w/ 3/8" Diffuser

### Hose & Diffuser –

Armored Hose CGA-295 with 1/2" Diffuser

Part #	Hose Length	Description
FPA4D12	4'	CGA-295 w/ 1/2" Diffuser
FPA6D12	6'	CGA-295 w/ 1/2" Diffuser
FPA8D12	8'	CGA-295 w/ 1/2" Diffuser
FPA12D12	12'	CGA-295 w/ 1/2" Diffuser



*In-line Swivel Assembly*

Part # **CC-ILS-ASSY**



*Hose Coupler CGA-295 Inert*

Part # **CGA-295COU**

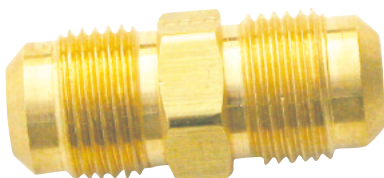

*Hose Coupler CGA-440 Oxygen*

5/8" x 5/8"

Part # **CGA-440COU**

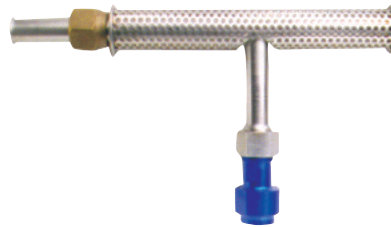

*P.B. Fill Adapter Assembly*

Part # **PB-FA-ASSY**

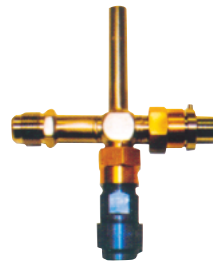

*2 Way Fill Head*

Part # **CC-FH-2WAY**

*3 Way Fill Head*

Part # **CC-FH-3WAY**

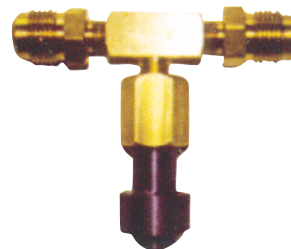

*P.B. In-Line Fill Head*

Part # **PB-ILFH**



### Teflon Tape

Part #	Description
Tape-1	1/4" Teflon Tape
Tape-2	1/2" Teflon Tape
Tape-34	3/4" Teflon Tape
Tape-3	1" Teflon Tape
Oxy-Teflon 8	Teflon Paste

### Green Oxygen Teflon Threaded Seal Tape



### Green Teflon Tape

Part #	Description
TAPE-2-GREEN	1/2" x 520" Green Teflon Tape
TAPE-34-GREEN	3/4" x 520" Green Teflon Tape