

Lockouts

*Ratermann
Manufacturing,
carries a
full line
of
Lockouts
for your
safety and
operational
use!*



INDEX

Lockouts

- Accessories for Padlocks
 - Lock Labels **17A-8**
 - Magnetic Lockout Signs **17A-8**
 - Self-Sticking Vinyl **17A-8**
- Ball Valve Lockouts **17A-4**
- Butterfly Valve Lockouts **17A-4**
- Circuit Breaker Lockouts **17A-5**
- Electrical Switch Lockouts **17A-5**
- Lock and Protect Your Valves
 - "The Original" Lockout **17A-3**
 - Electrical Plug Lockouts **17A-3**
- Lockout Kits **17A-12**
- Lockout Tags **17A-9**
 - Photo, Self Laminating Tag **17A-9**
 - Custom Tags **17A-9**
- Lockout/Tagout Identification **17A-10**
 - Marking Pen **17A-10**
- Lockout/Tagout Stations **17A-11**
- Metal Lockout Hasps **17A-6**
- New Safety Lockout Padlocks **17A-7**
- Padlocks **17A-7**
- Padlocks & Key
Storage Systems **17A-13**
- Safety Lockout Hasps **17A-6**
- What Is Lockout/Tagout? **17A-2**

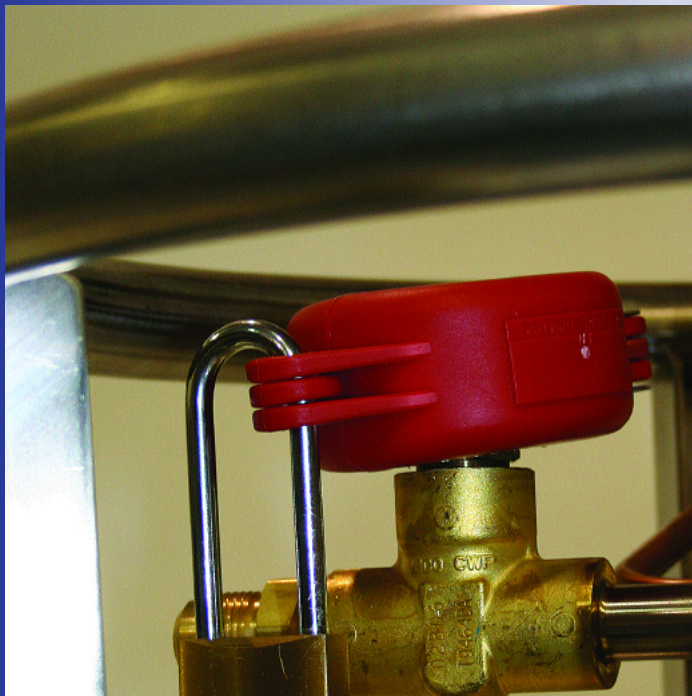

WHAT IS LOCKOUT/TAGOUT?

INTRODUCTION

Most industrial accidents are caused by the unexpected energization or start up of machines or equipment or by the uncontrolled release of energy. Many of these accidents can be prevented by proper LOCKOUT / TAGOUT procedures. OSHA's LOCKOUT / TAGOUT standard, 29 CFR & 1910.147 & 1910.269 are designed to prevent needless deaths and serious injuries to service and maintenance personnel by controlling unauthorized or accidental use of energy. To perform service and maintenance work on industrial equipment safely, you must understand the importance of energy control and OSHA's LOCKOUT / TAGOUT standard. You must also know how to apply energy isolation and LOCKOUT / TAGOUT.

WHAT IS LOCKOUT/ TAGOUT?

A LOCKOUT is a method of keeping equipment from being set in motion and endangering workers.

- A disconnect switch, circuit breaker, valve or other energy isolation mechanism is put in the safe or off position.
- A device is often placed over the energy-isolating mechanism to hold it in the safe position. This is where NORTH LOCKOUT / TAGOUT products are essential
- A lock is attached so that the equipment can't be energized. In a TAGOUT, the energy-isolating device is placed in the safe position and a written warning is attached to it. All lockout and tagout materials are supplied by the employer.

Each device must be:

- Durable, to withstand wear.
- Substantial, so it won't come off easily.
- Capable of identifying the person who applied it. Many companies issue each worker authorized to apply LOCKOUT / TAGOUT their own personal lock imprinted with his name.

WHEN SHOULD YOU LOCKOUT/TAGOUT?

LOCKOUT / TAGOUT is necessary whenever you are performing service or maintenance in proximity to a machine where you could be injured by:

- Unexpected start up of the equipment.
- Release of stored energy.

Two situations are most likely to need LOCKOUT / TAGOUT:

- When you must remove or bypass a guard or other safety device.
- When you must place any part of your body where you could be caught by moving machinery.

Some jobs for which LOCKOUT / TAGOUT should be used are:

- Repairing electrical circuits.
- Cleaning or oiling machinery with moving parts.
- Clearing jammed mechanisms.

OSHA lets each employer use LOCKOUT / TAGOUT or both. It's your responsibility to follow whichever system has been chosen for your workplace. Locks and Tags by themselves do not de-energize equipment. Attach them only after the machinery has been isolated from its energy sources.



APPLYING LOCKOUT/TAGOUT

- Energy isolation and LOCKOUT / TAGOUT are to be applied only by trained employees authorized to perform service or maintenance.
- Before LOCKOUT / TAGOUT is applied, all employees who work in the affected area must be notified.
- OSHA requires that control of hazardous energy be done according to a six-step procedure.

1 PREPARATION FOR SHUTDOWN

Before you turn off any equipment in order to lock or tag it out, you must know:

- The types and amounts of energy that power it.
- The hazards of that energy.
- How the energy can be controlled.

2 EQUIPMENT SHUTDOWN

- Shut the system down by using its operating controls.
- Follow whatever procedure is applicable for the equipment, so that you don't endanger anyone during shutdown.

3 EQUIPMENT ISOLATION

- Install all energy-isolating devices so that the equipment is isolated from its energy sources.
- Be sure to isolate all energy sources and secondary power supplies as well as the main one.
- Never pull an electrical switch while it is under load.
- Never remove a fuse instead of disconnecting the energy or power.

4 APPLICATION OF LOCKOUT / TAGOUT DEVICES

- All energy-isolating devices are to be locked, tagged or both according to your company LOCKOUT/TAGOUT procedures.
- Only the standardized devices supplied by your employer are to be used for LOCKOUT / TAGOUT, and they are not to be used for anything else.
- Use a LOCKOUT device if your lock cannot be placed directly on the energy control.
- When LOCKOUT is used, every employee can lock out a single energy-isolating device by using a multiple-lock hasp.
- For big jobs, a LOCKOUT box can be used to maintain control over a large number of padlocks and keys.
- If tags are used instead of locks, attach them at the same point as you would a lock, or as close to it as possible.
- Fill tags out completely and correctly.

5 CONTROL OF STORED ENERGY

Take any of the following steps that are necessary to guard against energy left in the equipment after it has been isolated from its energy sources.

- Inspect the system to make sure all parts have stopped moving.
- Install ground wires.
- Relieve trapped pressure.
- Release the tension on springs, or block the movement of spring-driven parts.
- Block or brace parts that could fall because of gravity.
- Block parts in hydraulic and pneumatic systems that could move from the loss of pressure.
- Bleed the lines and leave vent valves open.
- Drain process piping systems and close valves to prevent the flow of hazardous materials.
- If a line must be blocked where there is no valve, use a blank flange.
- Purge reactor tanks and process lines.
- Dissipate extreme cold or heat, or wear protective clothing.
- If stored energy can reaccumulate, monitor it to make sure it stays below hazardous levels.

6 EQUIPMENT-ISOLATION VERIFICATION

Take any of the following steps that fit your company's equipment and energy control program.

- Make sure all danger areas are clear of personnel.
- Verify that the main disconnect switch or circuit breaker can't be moved to the "on" position.
- Use a voltmeter or other equipment to check the switch.
- Press all start buttons and other activating controls on the equipment itself to ensure that it is isolated.
- Shut off all machine controls when the testing is finished.

PERFORMING THE WORK

- Look ahead, and avoid doing anything that could re-activate the equipment.
- Don't bypass the lockout when putting in new piping or wiring.

WARNING

These procedures alone do not give you all the tools you need to work safely around hazardous machines and energy sources. Your employer must have a written procedure and you must be trained in the use of LOCKOUT/TAGOUT devices. It is up to you to guard all workers and your own life and health by complying with these rules.

LOCK & PROTECT YOUR VALVES

WITH "THE ORIGINAL" LOCKOUT
SAFELY • EFFICIENTLY • INEXPENSIVELY



Special Application For Small Valves:
Modification: Drill a hole aligned with the first and close the lockout to completely cover the valve.

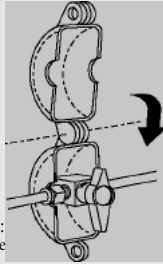









The V-SAFE valve cover consists of two flattened half moons that completely cover the valve wheel.

- Made of strong "Polypropylene" plastic.
- Fully dielectric.
- Highly resistant to cracking and abrasion.
- Resistant to extreme temperature changes from - 50° F (- 46° C) to 360° F (183°C).

TECHNICAL DATA 5 different sizes to cover valve handles from 1" to 14" diameter

Models	Inside Diameter	A	Inside Height	B	Outside Diameter	C	Outside Height	D	Lock Hole	E	Valve Handle Size
LO-VS02	2.750"		1.250"		3.000"		1.500"		0.312"		1" - 2 1/2"
	70 mm.		32 mm.		76 mm.		38 mm.		8 mm.		
LO-VS04	5.000"		1.250"		5.500"		1.750"		0.375"		2 1/2" - 5"
	130 mm.		32 mm.		140 mm.		44 mm.		9.5 mm.		
LO-VS06	6.500"		1.500"		7.000"		2.000"		0.375"		5" - 6 1/2"
	170 mm.		38 mm.		177 mm.		50 mm.		9.5 mm.		
LO-VS09	10.000"		2.000"		10.500"		2.500"		0.375"		6 1/2" - 10"
	257 mm.		50 mm.		267 mm.		63 mm.		9.5 mm.		
LO-VS13	14.000"		2.500"		14.500"		3.000"		0.375"		10" - 14"
	355 mm.		63 mm.		368 mm.		73.8 mm.		9.5 mm.		

COLOR CHOICES Colors recommended in ANSI Z39.1

RED LIQUID	YELLOW VENT	BLUE GAS	GREEN
			

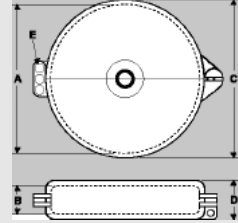

DRILL POINT: If needed, cut the recessed section with a knife to let the valve stem through into the open position.

ELECTRICAL PLUG LOCKOUTS

PROTECT YOUR EMPLOYEES WITH THE E-SAFE LOCK-A-PLUG

The E-SAFE "LOCK-A-PLUG" completely encloses the plug from any accidental reconnection. The electrical cable is inserted through the opening and then closed. The single entry (LO-LP110) or multiple entry (LO-LP550) locking system avoids usage by unauthorized personnel during critical times. The E-SAFE is a practical and positive protection system. Made out of "Polypropylene" plastic, it is totally dielectric, resists cold or hot temperatures up to 300° F / 149° C, has a sliding closure and an integrated multiple lockout.

INSTALLATION INSTRUCTIONS

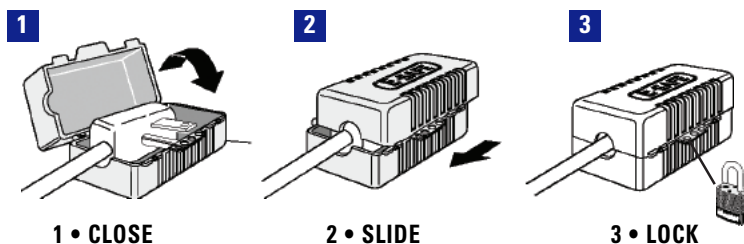

TECHNICAL DATA

Dimensions: E-SAFE LOCK-A-PLUG

Models	Inside Length	A	Inside Height	B	Inside Width	C	Cable Hole	D	Lock Hole	E
LO-LP110	3.250"		1.750"		1.750"		0.500"		0.312" dia	
	82 mm.		44.5 mm.		44.5 mm.		12 mm.		8 mm.	
LO-LP550	6.750"		3.000"		3.000"		1.000"		0.375" dia	
	170 mm.		76 mm.		76 mm.		25 mm.		9.5 mm.	

LO-LP110

Will accept 110 volts and certain models of the 220 volt plug up to 13/4" x 13/4" x 31/4" (44.5 mm. x 44.5 mm. x 82 mm.) in size with a maximum cable diameter of 0.500" (12mm.).

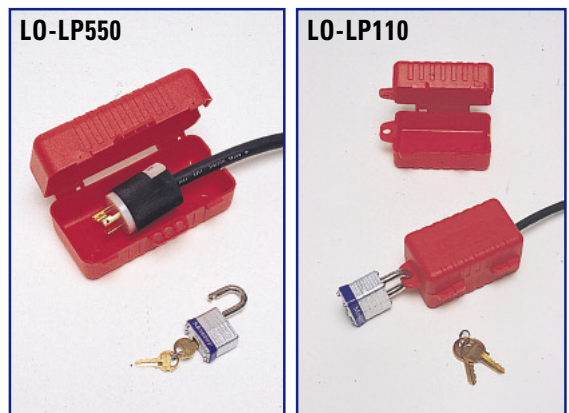

LO-LP550



LO-LP110



LO-LP550

Will accept 220 volts and 550 volt plugs up to 3" x 3" x 63/4" (76 mm. x 76 mm. x 170 mm.) in size with maximum cable diameter of 1.000" (25 mm.).

BALL VALVE LOCKOUTS

SAFELY • EFFICIENTLY • INEXPENSIVELY

- LO-BS0** Valves from 3/8" to 1 1/4" (9.5 mm. to 31.5 mm.)
- LO-BS02** Valves from 1 1/2" to 2 1/2" (37.5 mm to 62.5 mm.)
- LO-BS03** Valves from 2" to 8" (50 mm. to 200 mm.)

- Made of strong "Polypropylene" plastic.
- Fully dielectric.
- Highly resistant to solvents and other chemical products.
- Highly resistant to cracking and abrasion.
- Resistant to extreme temperature changes
- 50° F (- 46° C) to 360° F (183° C).



3 DIFFERENT SIZES TO LOCKOUT YOUR BALL VALVES.

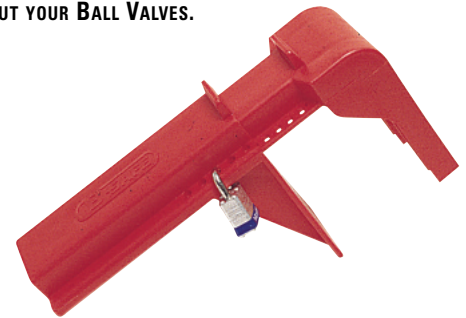
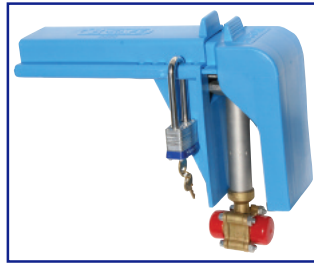

LO-BS03
The largest ball valve lockout available on the market.

AVAILABLE IN 4 COLORS:
RED, YELLOW, BLUE & GREEN (COLORS RECOMMENDED IN ANSI Z353.1)

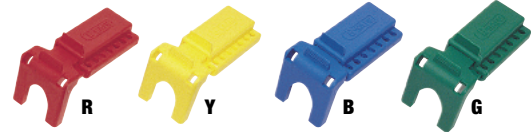

TECHNICAL DATA

Models	Width A	Height B	Length of Handle C	Lock Hole D
LO-BS01	3.100" 80 mm.	3.250" 82 mm.	5.375" to 7.500" 135 mm. to 190 mm.	0.312" dia. 8 mm.
LO-BS02	3.750" 95 mm.	5.000" 125 mm.	7.500" to 10.000" 190 mm. to 250 mm.	0.312" dia. 8 mm.
LO-BS03	4.000" 100 mm.	7.450" 186 mm.	12.000" to 17.500" 300 mm to 438 mm	0.312" dia. 8 mm.

Note: Only the LO-BS01 can lock in the open position.

ASSEMBLY INSTRUCTIONS

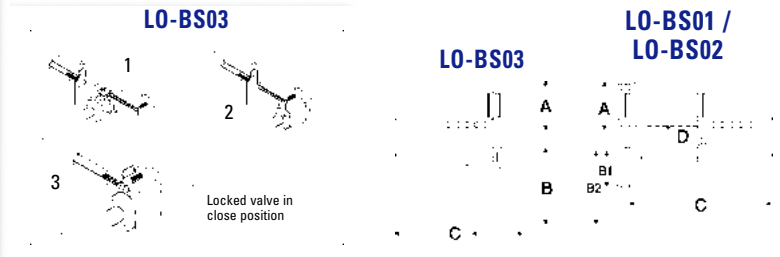
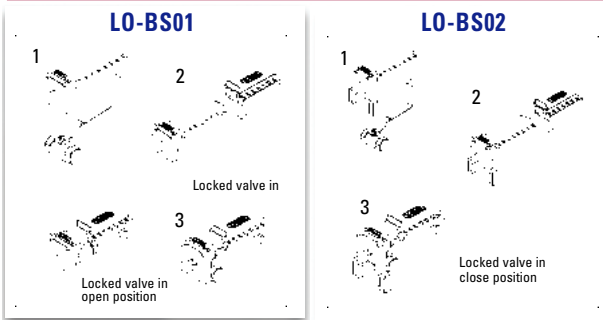

BUTTERFLY VALVE LOCKOUTS

THE ONLY WAY TO SECURE YOUR BUTTERFLY
UNIVERSAL LOCKOUT FOR BUTTERFLY VALVES

LO-BS04

Features:

- Made of strong "Polypropylene" plastic.
- Fully dielectric.
- Highly resistant to solvent and other chemical products.
- Highly resistant to cracking and abrasion.
- Resistant to extreme temperature changes
-50° F (-46° C) to 360°F (183° C).

AVAILABLE IN 4 COLORS: **RED, YELLOW, GREEN & BLUE**
(COLORS RECOMMENDED IN ANSI Z353.1)



TECHNICAL DATA

Model	Length A	Height B	Width C	Lock Hole D
LO-BS04	12" 305 mm.	2.750" 70 mm.	4.000" 102 mm.	0.375" 9.5 mm.

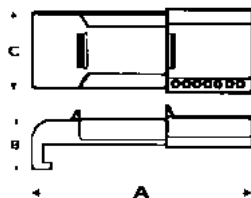

ASSEMBLY INSTRUCTIONS

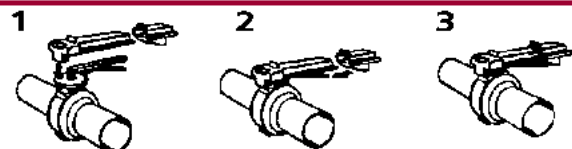

CIRCUIT BREAKER LOCKOUTS

Constructed of rigid plastic, the new C-SAFE circuit breaker lockouts are now available for either single or double pole circuit breaker lockout applications.



LO-CB01
A single pole lockout, CB01 requires a switch breaker with a recessed hole in it.



LO-CB02
The LO-CB02, is a double pole lockout and requires the breakers to be connected with a cross bar for lockout application.



LO-CB03
A single pole lockout, LO-CB03 does not require a switch breaker with a recessed hole in it.



LO-CB04
Our double pole circuit breaker lockout LO-CB04 will fit most major brands of electrical circuit breakers. If this lockout does not fit, it may be returned.

ASSEMBLY INSTRUCTIONS

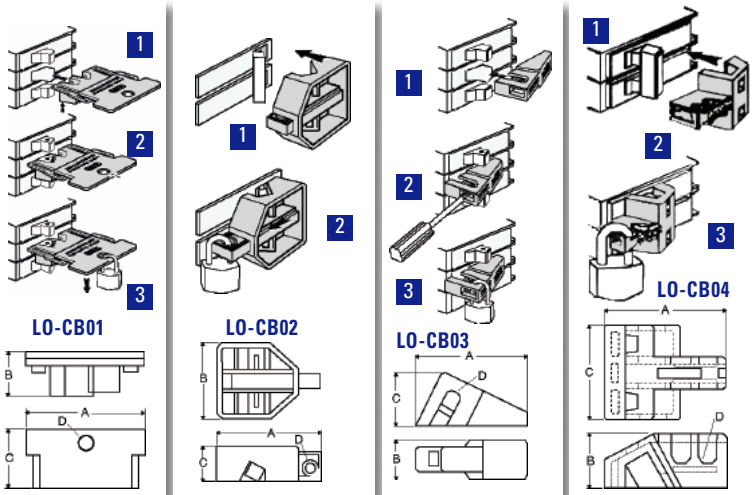

TECHNICAL DATA

DIMENSIONS: C-SAFE CIRCUIT BREAKER LOCKOUTS

Models	Length A	Height B	Width C	Lock Hole D
LO-CB01	2.300" 58 mm.	0.850" 22 mm.	1.100" 28 mm.	0.300" dia 7.5 mm.
LO-CB02	2.625" 66 mm.	1.875" 48 mm.	1.000" 25 mm.	0.300" dia 7.5 mm.
LO-CB03	2.300" 58 mm.	0.750" 19 mm.	1.000" 25 mm.	0.340" 8.5 mm.
LO-CB04	2.375" 60 mm.	1.000" 25 mm.	1.865" 47.5 mm.	0.375" 9.5 mm.

LO-CB01 Our single pole breaker lockout requires a single toggle with a recessed hole in it.
1 • To install, simply open the lock by sliding the base of the lock backwards.
2 • Place over the toggle, making sure that the small pole inside the lockout device is now inserted into the hole of the toggle. Close the lockout by pushing the base forward after ensuring that the holes are aligned.
3 • You are now ready to install your lock. This model will accommodate breakers up to 9/16" (14mm.) in width. **Remember**, the breaker must be in the "off" position before installing.

LO-CB02 Our double pole breaker lockout requires that there be two toggles connected together with a cross bar.
1 • To install, place over the toggles with the slotted side of the lockout covering the toggles.
2 • Pull the slide bar out to attach your lock. This model will accommodate breakers with an overall width of 5/8" (45mm).
Remember, the breaker must be in the "off" position before installing.

LO-CB03 This model is our single breaker lockout for circuit breakers that do not have a recessed hole.
1 • To install, the breaker must be in the "off" position. Place the breaker over the toggle.
2 • Insert your screwdriver (star type) into the hole, tighten the screws well.
3 • Insert your lock or tag and close. Make sure everything is tight.
This model will accommodate circuit breakers with an overall width of 9/16" (14mm).
Remember, the breaker must be in the "off" position before installing.

LO-CB04 Our double pole breaker lockout requires that there be two toggles connected together with a cross bar.
1 • Pull the slider bar and place the breaker lockout over the breakers.
2 • Push back the slider bar and put your lock on aligned holes.
This model will accommodate double or triple breakers.
Remember, the breaker must be in the "off" position before installing.

ELECTRICAL SWITCH LOCKOUT

THE ULTIMATE PROTECTION WITH THE E-SAFE LOCK-A-SWITCH

E-SAFE "LOCK-A-SWITCH" This easy to install device can be used with most mounted switches. It can be used to lock the switch in either the "on" or "off" position. (Install using existing screws). Standard package: 6 devices.

- 1 • Remove screws from switch plate.
- 2 • Adjust "E-SAFE" locking device over the switch plate and install it on switch.
- 3 • Position switch to desired position.
- 4 • Close "E-SAFE" device and put on your padlock and tag.

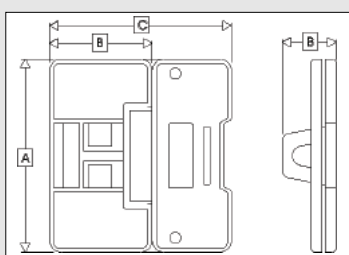

ASSEMBLY INSTRUCTIONS

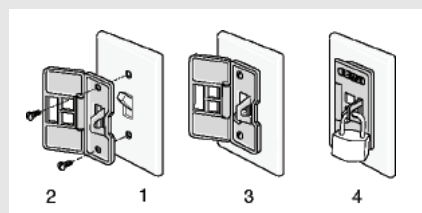

TECHNICAL DATA

Dimensions: E-SAFE LOCK-A-SWITCH

Model	Height A	Width Close B	Width Open C
LO-ES01	3.000" 76 mm.	1.625" 42 mm.	3.000" 76 mm.

SAFETY LOCKOUT HASPS

THE TOTALLY DIELECTRIC LOCKOUT

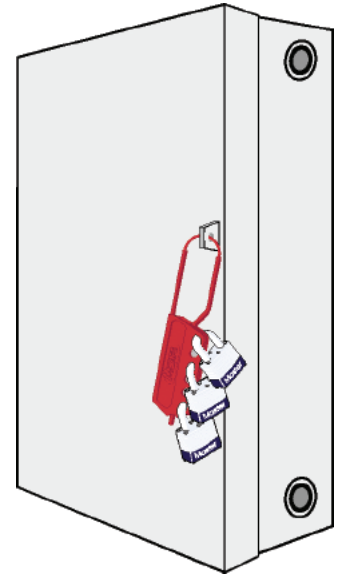

#LO-MS01

Features:

- Made of Heavy Duty Nylon
- Bright Red Color for Hi-Visibility
- Unbreakable
- Heat & Cold Resistant
- Highly Flexible
- Holds 6 Padlocks
- Dielectric

INEXPENSIVE • VERSATILE • DIELECTRIC

MORE THAN ONE EMPLOYEE CAN LOCKOUT THE SAME ENERGY SOURCE FOR ADDED SAFETY

METAL LOCKOUT HASPS

Four models available

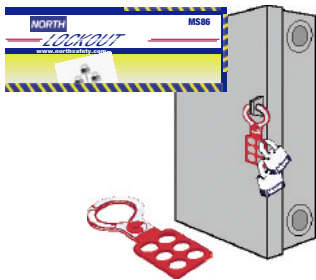

LO-MS86

METAL LOCKOUT HASP

With 1" dia. jaw opening, 4 3/8" length, Single scissor type, Rubber dipped handle, Accommodates six padlocks, made of tempered steel, individually packed-72/box.

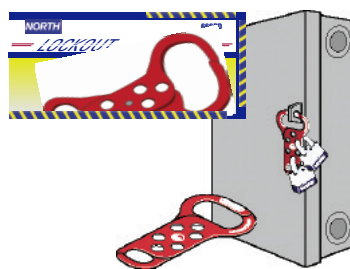

LO-666RD

METAL LOCKOUT HASP

Dual opening, 1 3/4" dia. and 3/4" dia. Dual scissor type 5 1/4" length. Painted red. Accommodates six padlocks, made of tempered steel, individually packed-60/box.

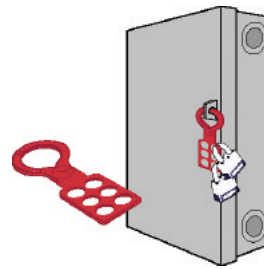

LO-R60ML

METAL LOCKOUT HASP

With 1" dia. jaw opening, 4 3/8" length. Single scissor type. Painted red. Accommodates six padlocks, made of tempered steel, bulk pack-96/box.

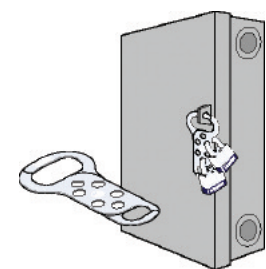

LO-666

METAL LOCKOUT HASP

Dual opening, 1 3/4" dia. & 3/4" dia. Dual scissor type 5 1/4" length, Plated steel to resist rust (clear). Accommodates six padlocks, made of tempered steel, bulk pack-96/box.

ALL THESE LOCKOUT HASPS WILL ACCEPT SIX PADLOCKS UP TO 3/8" DIAMETER SHACKLES WITH SIX LOCKOUT TAGS

MASTER-KEYED SYSTEMS

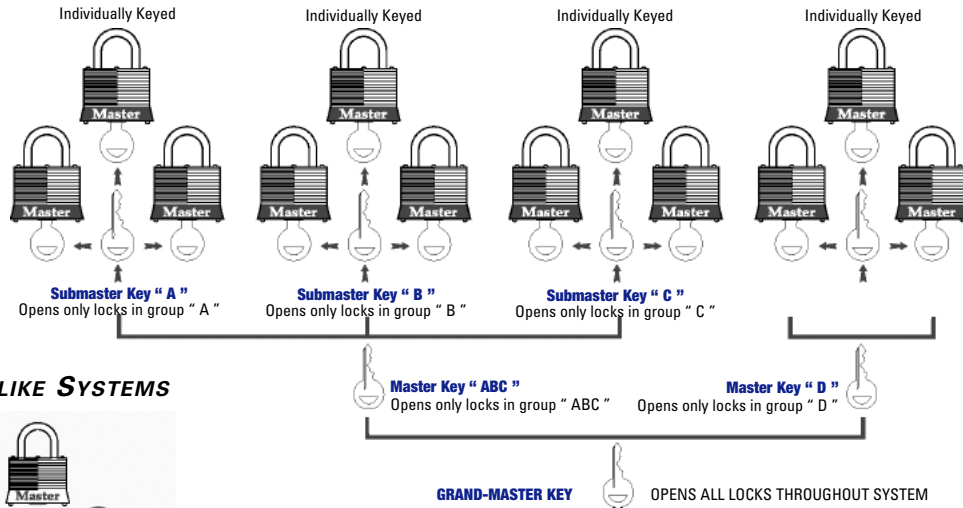

KEYED-ALIKE SYSTEMS

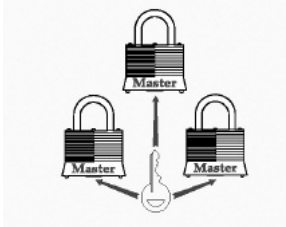

MODELS	DESCRIPTION
PADLOCK	1 1/2" (38 mm.) wide laminated steel body with case hardened steel shackle
LO-3D	Individually keyed, regular shackle
LO-3DLF	Individually keyed, 1 1/2" shackle
LO-3DLH	Individually keyed, 2" shackle
LO-3KA	Keyed alike, regular shackle
LO-3KALF	Keyed alike, 1 1/2" long shackle
LO-3KALH	Keyed alike, 2" long shackle
LO-3MK	Master keyed, regular shackle
LO-3MKLF	Master keyed, 1 1/2" shackle
LO-3MKLH	Master keyed, 2" shackle
LO-2K	Master Key
PADLOCK	1 3/4" (45 mm.) wide laminated steel body with case hardened steel shackle
LO-1D	Individually keyed, regular shackle
LO-1DLF	Individually keyed, 1 1/2" shackle
LO-1DLJ	Individually keyed, 2 1/2" shackle
LO-1KA	Keyed alike, regular shackle
LO-1KALF	Keyed alike, 1 1/2" long shackle
LO-1KALJ	Keyed alike, 2 1/2" long shackle
LO-1MK	Master keyed, regular shackle
LO-1MKLF	Master keyed, 1 1/2" shackle
LO-1MKLJ	Master keyed, 2 1/2" shackle
LO-2K	Master Key
PADLOCK	2" (50 mm.) wide laminated steel body with case hardened steel shackle
LO-5D	Individually keyed, regular shackle
LO-5DLF	Individually keyed, 1 1/2" shackle
LO-5DLJ	Individually keyed, 2 1/2" shackle
LO-5KA	Keyed alike, regular shackle
LO-5KALF	Keyed alike, 1 1/2" long shackle
LO-5KALJ	Keyed alike, 2 1/2" long shackle
LO-5MK	Master keyed, regular shackle
LO-5MKLF	Master keyed, 1 1/2" shackle
LO-5MKLJ	Master keyed, 2 1/2" shackle
LO-2K	Master Key

• MASTER-KEYED SYSTEMS

Supervisory master-key opens all locks in system yet each padlock also opens with a separate individual key. Permits organizing submaster, master and grandmaster systems along departmental or other functional lines, as illustrated (Padlocks are specially configured, regular locks will not accommodate Master-keying).

• KEYED-ALIKE SYSTEMS

Locks in KA sets employ identical keys. One key opens all in set.

NEW SAFETY LOCKOUT PADLOCKS

COMPLETE AND EASY OSHA DEVICE COMPLIANCE



Dedicated safety lockout padlock with 1.5" shackle. Available in 8 colors.

It's a safe bet you won't confuse our new safety lockout padlocks with any other locks. Eight vibrant colors, two sizes, and permanent write-on labeling allow for versatile, readily distinguishable coding. The Xenoy® body is lightweight and nonconductive, yet strong, durable and unaffected by the elements and harsh working environments. Even the keyway is unique, ensuring the integrity of your key system. A single, dedicated safety key is provided per lock and its retained until the lock is closed, to aid OSHA compliance. If you're looking to enhance safety, this is the lock you've been looking for.

• Solid Body Bright Colors / 2 Body Sizes

- Red-Orange-Green-Teal-Purple-Black-Blue
- Easy identification by department or trade from distance.

• Personal Integrated Identification

- Quick on-site employee ID capability with permanent write-on labels (2 labels supplied for each lock).

• Xenoy® Body Construction

- Tamper resistant, lightweight, non conductive body that is ultrasonically welded for strength and durability
- Better chemical / harsh environment resistance over steel and aluminum products
- Surpasses environmental industrial test criteria.

No.	Description	Qty.	Wt. per Shelf Pack (Lbs.)
LO-410	1 1/2" wide, 1 3/4" high, 1 1/2" shackle	1	2
LO-410KA	Keyed Alike	1	2
LO-410MK	Master Keyed	1	2
LO-410KAMK	Keyed Alike, Master Keyed	1	2
LO-4105701	Label sheet for Padlock-"Property of/Danger"	49	N/A
LO-411	1 1/2" wide, 3" high, 1 1/2" shackle	1	2
LO-411KA	Keyed Alike	1	2
LO-411MK	Master Keyed	1	2
LO-411AMK	Keyed Alike, Master Keyed	1	2
LO-4115701	Label sheet for Padlock-"Property of/Danger"	28	N/A
LO-400K	Master Key		

All padlocks come with a standard blue bumper. Color code lock available (bumper): black, white, red, green, yellow. Add color after model number. For master key color coding bumper (min. of 30 units). Available upon request

ACCESSORIES FOR PADLOCKS

• Identification Tags and Collars

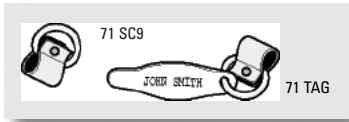

- # LO-71 TAG 1/2" x 13/4" BRASS TAG WITH RING (PACK OF 12)
- # LO-71 SC9 COLLAR COMPLETE WITH RIVETS FOR TAG (PACK OF 12)

• Padlock Eyes

These padlock eyes will help you comply with OSHA standards, when the equipment has to be modified to accept locks and lockout devices. Two types of mounting eyes are available. Surface mount or inside mount.

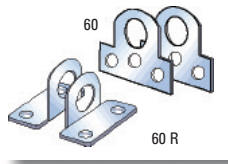

- # LO-60 SURFACE MOUNT (FLAT) AVAILABLE IN PACK OF 12 PAIRS
- # LO-60R INSIDE MOUNT (RIGHT ANGLED) AVAILABLE IN PACK OF 6 PAIRS



• Chain Attachment

9" chain with chain holder for permanently attaching lockouts at pre-designated locations (control or valve sites).
#LO-71CS 9" chain attachment with chain holder. Available in pack of 12

• Group Lock Box

To be used for work team lockout situations where there are multiple employees, energy sources, machines and processes to be locked out. All keys are stored in the lock box. The group leader or foreman then locks the box until the job is complete and all group members are cleared from work area. Heavy steel construction.



- # LO-GLB01 Group lock box.

• 13 Lock Group Lock Box

Simplifies lockout of large equipment. After machine or process is locked out, the key or keys are placed in a lock box. Then, each authorized work team member places a personal lock or tagout device to the group lock box. Ensures that no one employee has access to the box unless all employees have removed their locks or tags. Accepts up to 13 individual locks. Heavy steel construction.



- # LO-GLB02 Group lock box.

LOCK LABELS

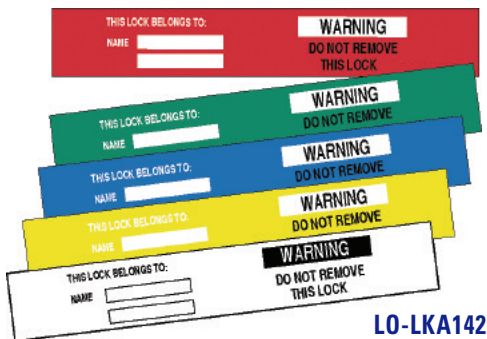

LO-LKA142

3/4" x 5"

Self-laminating padlock labels are an easy way to identify employee's locks. These labels are made of aluminum foil with permanent pressure-sensitive adhesive backing. Write on decals with ballpoint pen or typewriter.

Available in: Red, Green, Blue, Yellow or White.

STANDARD PACKAGE (50 UNITS)
TO ORDER SPECIFY # ITEM, MATERIAL AND COLOR



MAGNETIC LOCKOUT SIGNS

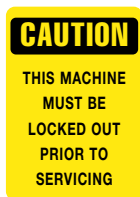

3 1/2" x 5"
7" x 5" LO-LKA134



3 1/2" x 5"
7" x 5" LO-LKA136



3 1/2" x 5"
7" x 5" LO-LKA138



Magnetic signs stay put when placed on a metal surface and the magnetic material allows the signs to be moved to where employees attention is needed.

3 1/2" x 5"
7" x 5" LO-LKA140

3 1/2" x 5" add suffix/3mg
7" x 5" add suffix/4mg

SELF-STICKING VINYL

<p>2 1/4" x 4 1/2" LO-LKA124</p>	<p>2 1/4" x 4 1/2" LO-LKA122</p>	<p>add suffix:</p> <p>2 1/4" x 2 1/4" /1SV</p> <p>3 1/2" x 5" /3SV</p> <p>5" x 7" /4SV</p>
<p>2 1/4" x 4 1/2" LO-LKA128</p>	<p>2 1/4" x 4 1/2" LO-LKA130</p>	
<p>2 1/4" x 4 1/2" LO-LKA126</p>	<p>3 1/2" x 5" 5" x 7" LO-LKA132</p>	

STANDARD PACKAGE (10 UNITS)

LOCKOUT TAGS

All lockout tags are 3" x 5 3/4" in size and made of rugged stain and mildew resistant 20 mil. styrene. The textured surface allows you to write all important information such as names, dates and expected completion time as well as any other remarks.

These tags are sold in packs of 25 identical tags with necessary fasteners. Also available with grommets for greater strength.

NOTE: All lockout tags are red striped for easier identification.



LO-ELA260



LO-ELA210

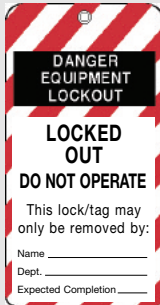
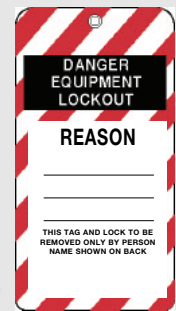

LO-ELA230



LO-ELA235

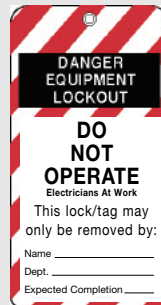

LO-ELA240



LO-ELA245

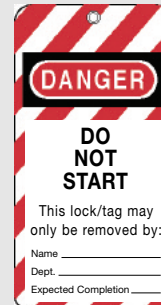

LO-ELA250

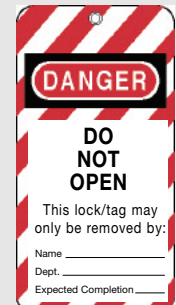

LO-ELA255

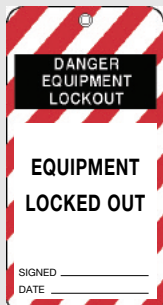

LO-ELA265



LO-ELA270

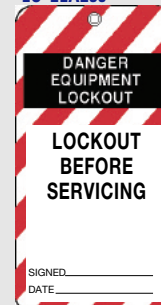

LO-ELA275



LO-ELA280



LO-ELA285

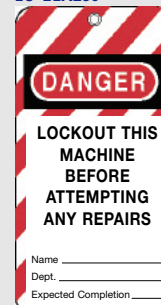

LO-ELA200



LO-ELA205



LO-ELA215



LO-ELA225



LO-ELA290



LO-ELA295



LO-ELA297



LO-ELA299

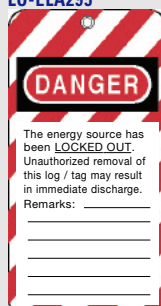

REVERSE SIDE #1

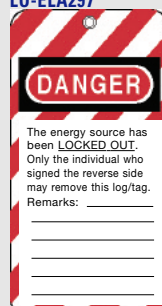

REVERSE SIDE #2



REVERSE SIDE #3

PHOTO, SELF LAMINATING TAG

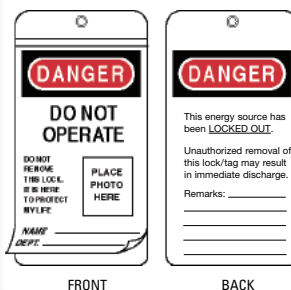

SELF LAMINATING TAG

For easy identification of individuals working on equipment. These tags are made of rigid vinyl with polyester over laminate to protect the photo and other written data. To use, lift vinyl films, enter all information, place photo on tag and smooth laminate film back onto the tag.

- These tags are sold in packs of 25 with necessary fasteners.
- These tags are also available with grommets for longer wear.

CUSTOM TAGS

A variety of custom tags options are available to meet your specific needs. Tags are available in 3 colors: White, Yellow or Orange.

Material: .020 mil styrene.

REGULAR OR LAMINATED



LO-EEA305



LO-EEA305L

- These tags are sold in packs of 25 with necessary fasteners.
- These tags are also available with grommets for longer wear.

HOW TO ORDER

Models	Regular EEA305	Laminated EEA305L	Specified legend:
Colors:	White (W), Yellow (Y), Orange (O)	White (W), Yellow (Y), Orange (O)	FRONT & BACK
Headers:	Danger (D), Caution (C), Warning (W)	Danger (D), Caution (C), Warning (W)	

REVERSE SIDE OPTIONS

LOCKOUT/TAGOUT IDENTIFICATION



3 1/2" x 5"
7" x 10" - 10" x 14" **LO-LKA102**



3 1/2" x 5"
7" x 10" - 10" x 14" **LO-LKA108**



3 1/2" x 5"
7" x 10" - 10" x 14" **LO-LKA116**



3 1/2" x 5"
7" x 10" - 10" x 14" **LO-LKA118**



3 1/2" x 5"
7" x 10" - 10" x 14" **LO-LKA104**



3 1/2" x 5"
7" x 10" - 10" x 14" **LO-LKA110**



LOCKOUT PROCEDURES ARE POSTED IN THE OPERATING AREA AND / OR BY THE MAIN ENERGY SOURCE OF EACH MACHINE.

IF YOU HAVE ANY QUESTIONS ABOUT THE LOCKOUT PROCEDURES, PLEASE SEE YOUR SUPERVISOR OR THE SAFETY DIRECTOR.

THE STANDARD WILL BE STRICTLY ENFORCED.

14" x 20"
Styrene only **LO-LKA114/7ST**



3 1/2" x 5"
Vinyl only **LO-LKA120**

DIMENSIONS	3 1/2 x 5	7 x 10	10 x 14	14 x 20
	• STYRENE		5ST	6ST
• SELF-STICK VINYL	3VY	5VY	6VY	
• SELF-STICK POLYCARBONATE		5PA	6PA	
• POLYCARBONATE LAMINATED ON ALUMINIUM		5PM	6PM	



3 1/2" x 5"
7" x 10" - 10" x 14" **LO-LKA106**



3 1/2" x 5"
7" x 10" - 10" x 14" **LO-LKA112**

TO ORDER SPECIFY ITEM #, SIZE AND MATERIAL

MARKING PENS

Fast drying permanent ink,
Fine tip.



USED ON SAFETY TAGS

Models No.	Color	Description	Qty/Pkg
LO-PEN 1	Black	Color of cap indicates	12
LO-PEN 2	Red	color of ink	12

Plastic Only

LOCKOUT / TAGOUT IDENTIFICATION

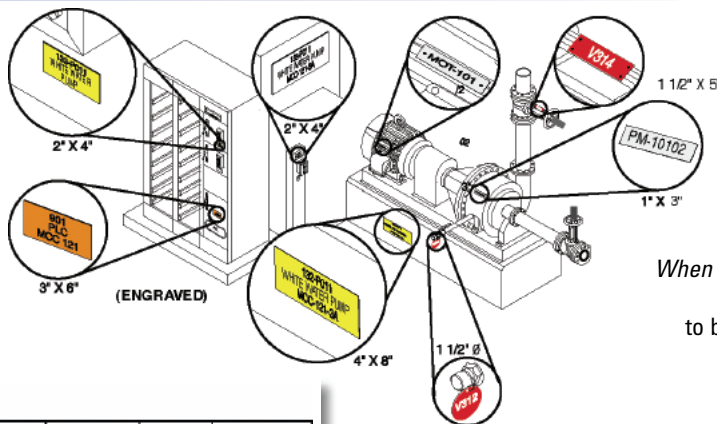

Colors available:



EQUIPMENT TAGS

MODELS	MAT.	SIZE	Up to 4 lines
IDA1X3/1	ALUMINUM	1" X 3"	1 2
IDA2X4/1		2" X 4"	1 2
IDP1X3/2	LAMICOID	1" X 3"	1 or 2 3 or 4
IDP2X4/2		2" X 4"	1 or 2 3 or 4
IDP3X6/2	PLASTIC	3" X 6"	1 or 2 3 or 4
IDP4X8/2		4" X 8"	1 or 2 3 or 4
IDS1X3/1	STAINLESS	1" X 3"	1 2
IDS2X4/1	STEEL 1/32"	2" X 4"	1 2

When Ordering Equipment Tags

Add **LO-** to beginning of model number when ordering. For example, model number IDA1X3/1 will become **LO-IDA1X3/1**

When Ordering Add **LO-** to beginning of model number when ordering. For example, model number IDVLR01 will become **LO-IDVLR01**

MODELS	MATERIALS		
IDVLR01	BRASS	●	
IDVLT01		1/32"	▲
IDVLC01		1/32"	■
IDVAR01	ALUMINUM	●	
IDVAT01		1/32"	▲
IDVAC01		1/32"	■
IDVPC02	LAMICOID	●	
IDVPR01		PLASTIC	▲
IDVPT01		1/16"	■
IDVPC01	1 side	—	
IDVPC02		2 sides	—
IDVPC03		—	—

LOCKOUT/TAGOUT STATIONS

North offers convenient and high visibility Lockout / Tagout centers that make your Locks, Tags, Lockout Hasps and Lockout devices (V-SAFE, B-SAFE, C-SAFE and E-SAFE and M-SAFE Hasps) easy to find and use. These Lockout / Tagout centers are built for the toughest conditions. They are made of double molded polystyrene with plastic or metal hanging hooks for locks and lockout hasps.

LO-LSE101 (Panel only)
LO-LSE101 F (Panel complete w/fill)

QTY.	CONTENTS
1 ea.	LO-LSE101 Lockout Panel
2 ea.	LO-VS02 V-SAFE lockout 2"
1 ea.	LO-VS04 V-SAFE lockout 4"
1 ea.	LO-VS06 V-SAFE lockout 6"
1 ea.	LO-BS01 B-SAFE lockout
2 ea.	LO-LP110 E-SAFE lockout 110-220 volts.
1 ea.	LO-LP550 E-SAFE lockout 220-550 volts.
1 ea.	LO-MS86 M-SAFE metal hasp.
4 ea.	LO-MS01 M-SAFE nylon hasp.
1 ea.	LO-ELA290 DO NOT OPERATE TAGS /25 LO- ELA255
1 ea.	DO NOT OPEN TAGS /25
1 ea.	LO-3D Master lock

18" x 24"

SMALL LOCKOUT STATIONS
Model: **LO-LSE101 F (Full)**



LO-LSE102 (Panel only)
LO-LSE102 F (Panel complete with fill)

QTY.	CONTENTS
1 ea.	LO-LSE102 Lockout Panel
2 ea.	LO-VS02 V-SAFE lockout 2"
1 ea.	LO-VS04 V-SAFE lockout 4"
1 ea.	LO-VS06 V-SAFE lockout 6"
1 ea.	LO-VS09 V-SAFE lockout 9"
1 ea.	LO-BS01 B-SAFE lockout
1 ea.	LO-BS02 B-SAFE lockout
2 ea.	LO-LP110 E-SAFE lockout 110-220 volts.
1 ea.	LO-LP550 E-SAFE lockout 220-550 volts.
2 ea.	LO-MS86 M-SAFE metal hasp
6 ea.	LO-MS01 M-SAFE nylon hasp
1 ea.	LO-ELA290 DO NOT OPERATE TAGS /25
1 ea.	LO-ELA250 DO NOT START TAGS / 25
1 ea.	LO-ELA255 DO NOT OPEN TAGS / 25
2 ea.	LO-3D Master lock
2 ea.	LO-3DLF Master lock

24" x 35"

LARGE LOCKOUT STATIONS
Model: **LO-LSE102 F (Full)**

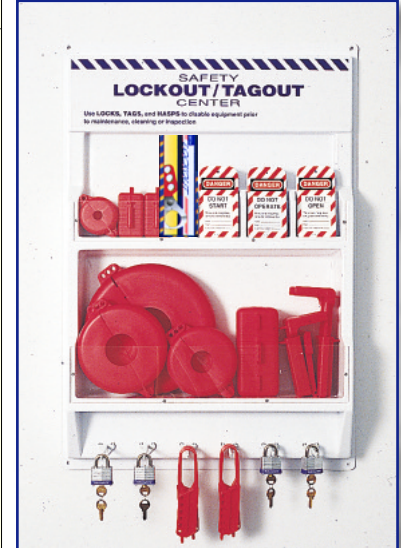

LOCKOUT STATIONS



PERSONAL LOCKOUT STATION (11" x 14")

LO-LSE103 Station only.
LO-LSE103F Station with fill.

- Contents:**
- 4 ea. 3D Master locks (Blue bumper padlock).
 - 1 pk. ELA290 DO NOT OPERATE TAGS (Pack /25).

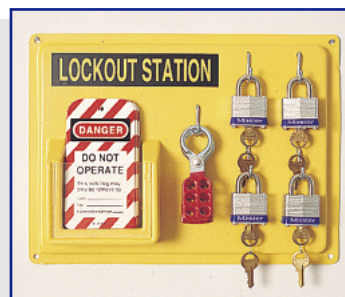

4 LOCKOUT STATION (11" x 14")

LO-LSE104 Station only.
LO-LSE104F Station with fill.

- Contents:**
- 4 ea. 3D Master locks (Blue bumper padlock).
 - 1 pk. ELA290 DO NOT OPERATE TAGS (Pack /25).
 - 3 R60 ML 1" SAFETY LOCKOUT HASPS.

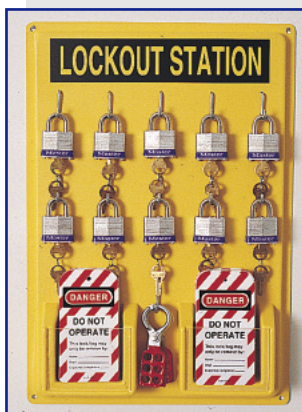

TEN LOCKOUT STATION (14" x 21")

LO-LSE105 Station only.
LO-LSE105F Station with fill.

- Contents:**
- 10 ea. 3D Master locks (Blue bumper padlock).
 - 2 pk. ELA290 DO NOT OPERATE TAGS (Pack /25)
 - 3 R60 ML 1" SAFETY LOCKOUT HASPS.



Departmental Lockout Station (21" x 29")

LO-LSE106 Station only.
LO-LSE106F Station with fill.

- Contents:**
- 20 ea. 3D Master locks (Blue bumper padlock).
 - 4 pk. ELA290 DO NOT OPERATE TAGS (Pack /25).
 - 6 R60 ML 1" SAFETY LOCKOUT HASPS.

NOTICE: Each lock is keyed differently, unless advised otherwise.

LOCKOUT KITS



LO-LK107FE Lockout/Tagout Kit

It is imperative that workers properly lockout/tagout machinery and equipment to prevent serious injury. The lockout kit provides all items required to make lockout/tagout as convenient and easy as possible.

Includes:

- (1) 16" tool box w/tray, (1) LO-VS02, (1) LO-BS01, (1) #3D, (1) #1DLJ, (1) LO-MS01, (5) LO-ELA290, (1) LO-CB04, (1) LO-CB03, (1) LO-ES01, (1) LO-LP110.

LO-LK108FE Electrical Lockout/Tagout Kit

This kit provides all items to properly secure electrical machinery and equipment from causing serious injury while being serviced. All items can be easily carried in lightweight carrying bag.

Includes:

- (1) Nylon carrying bag, (6) LO-CB03, (6) LO-CB01, (6) LO-CB04, (6) LO-ES01, (1) LO-LP110, (1) LO-LP550, (2) LO-MS01, (1) LO-666RD, (2) #3D, (2) #1DLJ, (10) LO-ELA290.



LO-LK109FE Valve Lockout/Tagout Kit

North has the original B-Safe ball and V-Safe gate valve lockouts. These make lockout/tagout of valves an easy procedure with an easy to transport lockout/tagout kit.

Includes:

- (1) Nylon carrying bag, (2) LO-VS02, (2) LO-VS04, (2) LO-BS01, (2) LO-BS02, (1) LO-MS01, (2) LO-666RD, (2) #3D, (2) #1DLJ, (10) LO-ELA290.



LO-LK110FE Combination Lockout Kit

North has combined Electrical - Valves - Hasps - Tags - Locks into a convenient kit for employees to properly lockout /tagout most applications.

Includes:

- (2) Nylon carrying bags, (6) LO-CB01, (6) LO-CB03, (6) LO-CB04, (6) LO-ES01, (1) LO-LP110, (1) LO-LP550, (2) LO-VS02, (2) LO-VS04, (2) LO-BS01, (2) LO-MS01, (2) LO-666RD, (6) #3D, (6) #1DLJ, (25) LO-ELA290.



LO-LK111FE Electrical Lockout Pouch

For convenient Electrical Lockout/Tagout North has created a zipper pouch that can be easily carried on your belt with all the necessary products. This ensures you or your workers have their lockouts when they need them.

Includes:

- (1) Double belt loop zippered pouch, (1) LO-LP110, (1) LO-MS01, (2) LO-CB03, (2) LO-CB04, (2) LO-ELA290, (1) #1DLJ.

LO-LK112F Electrical Breaker Lockout Pouch

When regular lockout/tagout on electrical panels is required, North has a convenient pouch that can be attached to a belt for easy use, including all products for proper lockout.

Includes:

- (1) Double belt loop zippered pouch, (3) LO-ES01, (1) LO-LP110, (4) LO-CB04, (4) LO-CB03, (1) LO-CB02, (2) LO-CB01.



A PADLOCK STORAGE MODULE

Made of melamine which have been adapted to an industrial environment, this module provides for the orderly storage and safekeeping of personal, serial numbered and borrowed padlocks used in safety lockout procedures.

Its transparent door provides continuous visibility of all padlocks presently stored.



Models	Sizes L x W x H	Number of Padlocks			Hook Type and Capacity		
		2 1/4" 58 mm	3" 78 mm	4" 102 mm	1	2	5
ID001/151	15" X 15" X 3"	16	12	8	•	•	•
ID001/152		32	24	16			
ID001/153		80	60	40			
ID001/301	15" X 30" X 3"	36	28	20	•	•	•
ID001/302		72	56	40			
ID001/303		180	120	80			
ID001/241	24" X 30" X 3"	63	49	35	•	•	•
ID001/242		126	98	70			
ID001/243		315	245	175			

When Ordering above Padlock Storage Modules

Add **LO-** to beginning of model number when ordering.

For example, model number ID001/151 will become **LO-ID001/151**

B TAGOUT SHEET MODULE

This module's transparent door allows the safety Tagout / Lockout sheet to be clearly seen during the lockout process. Also, the keys for the serial numbered padlocks to be used during the lockout application are clearly visible eliminating any possibility of accidental machine start-up.



Models	Size of Sheet	Sizes
ID004	8.5" x 11" (21.5 cm. x 28 cm.)	12" X 15" X 3"
ID005	8.5" x 14" (21.5 cm. x 28 cm.)	12" X 16 1/2" X 3"

When Ordering above Tagout Sheet Module

Add **LO-** to beginning of model number when ordering.

For example, model number ID004 will become **LO-ID004**

C KEYS STORAGE MODULE

This module, which is very useful in padlock management, allows the person responsible for lockout to maintain the duplicates of all padlock keys (Personal, serial numbered, borrowed, etc.) up to date.

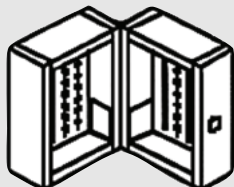

Models	Description	Sizes
ID 002/32	Module simple 32 keys	10 X 10 X 3"
ID 002/72	Module simple 72 keys	10 X 20 X 3"
ID 002/128	Module simple 128 keys	18 X 18 X 3"
ID 003/64	Module simple 64 keys	10 X 10 X 6"
ID 003/144	Module simple 144 keys	10 X 20 X 6"
ID 003/256	Module simple 256 keys	18 X 18 X 6"

When Ordering Keys Storage Module

Add **LO-** to beginning of model number when ordering.

For example, model number ID 002/32 will become **LO-ID 002/32**

D COMBINATION (Model #LO-ID-006)

Various combinations of the modules described above are possible. Shown here is the combination most frequently used in industry. It comprises a double visibility module combined with a padlock module to create a "Safety Lockout Station".

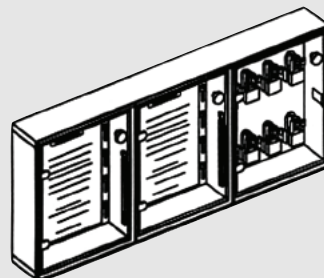

VALVE LOCKOUT APPLICATION



*Valve Lockout
photo shown with
pt# LO-VS04 on a
4 5/8 diameter valve
handwheel*

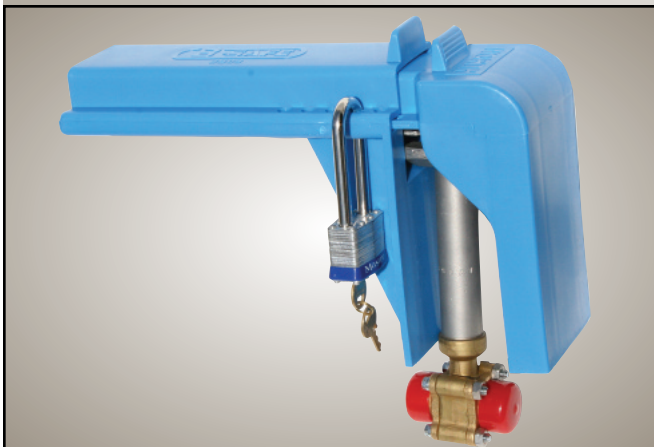

1 1/4 wide Ball Valve Handle Lockout part # LO-BS03B



Dewar Valve Lockout part # LOVS02R